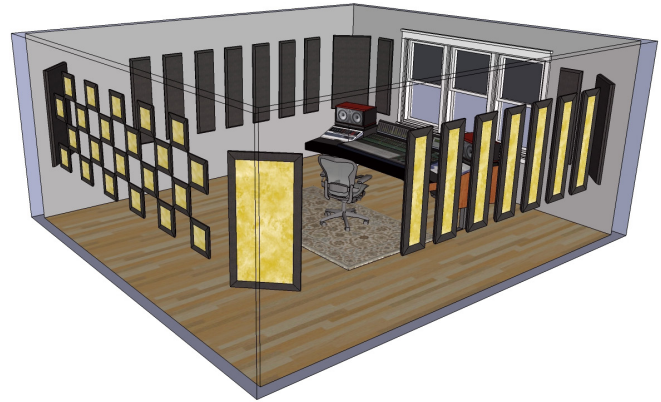

LONDON 16 ROOM KIT

The London 16™ room kit is designed for rooms up to 200 sq ft (18.6 sq m) and above, for smaller rooms where maximum absorption and accuracy are required or to provide lighter treatment in larger spaces. Ideally suited for studio control rooms, tracking rooms, or large home theaters, this kit provides everything needed for a complete acoustic treatment package.

The London 16 contains London Bass Traps that tackle problems that affect any room, such as primary reflections, flutter echo, standing waves and excessive bass. In addition to acoustic panels, each London 16 room kit includes the corresponding mounting hardware and instructions for easy installation.

Broadway panels are made from high-density 6lb per cubic foot glass wool, offering nearly five times greater absorption than typical low cost foam alternatives. This means that you get more absorption with fewer panels, while assuring an even absorption curve throughout the frequency range. The London 16 room kit is available in three colors: black, beige and grey. 44 panels included.

SPECIFICATIONS:

ORDER NUMBER	Z900-0160-XX (xx denotes color code 00=Black; 03= Beige; 08=Grey)
SURFACE COVERAGE	120 sq/ft (11.2 sq/m)
RECYCLED CONTENT	Up to 40%
LEED ELIGIBLE	Yes

ABSORPTION CHARACTERISTICS:

Sound absorption coefficient data

PANEL DEPTH	125Hz	250Hz	500Hz	1kHz	2kHz	4kHz	NRC
1" (25mm) Depth*	0.17	0.28	0.81	1.00	1.02	0.95	0.80
2" (51mm) Depth*	0.45	0.83	1.07	1.00	1.01	1.00	1.00
2" (51mm) Depth (corner mounted**)	0.68	1.2	1.07	1.00	1.01	1.00	1.00

* Testing performed by Riverbank Acoustical Laboratories. The test method conform explicitly with the requirements of the ASTM Standard Test Method for Sound Absorption and Sound Absorption Coefficients by the Reverberation Room Method: ASTM C 423-02a and E795-05. ** Typical performance based on quarter wavelength calculations.

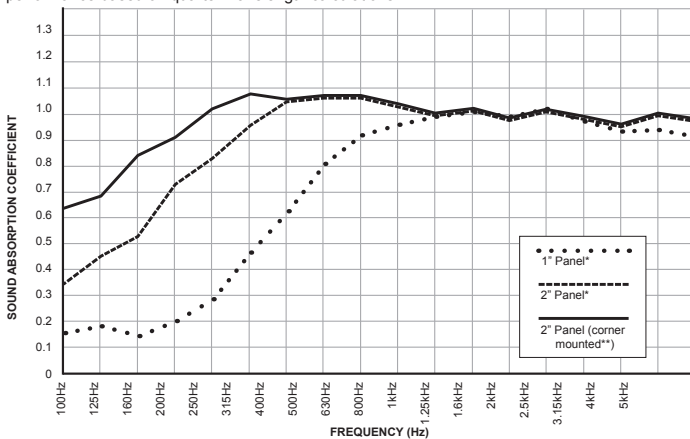
FIRE & BURN PERFORMANCE:

COUNTRY	TEST STANDARD	CLASSIFICATION
FABRIC WRAP		
Canada	CAN/ULC-S102-03	Class A/1
USA	ASTM E84-09	Class A/1
Europe	EN 13501-1	A2-s1, d0
Australia / New Zealand	AS/NZS 1530.3	(I)0, (S)0, (H)0, (Sm)5
PAINTABLE		
Canada	CAN/ULC-S102-10	Class A/1
USA	ASTM E84-11b	Class A/1
Europe	EN 13501-1	B-s2, d0
Australia / New Zealand	AS/NZS 1530.3	(I)0, (S)0, (H)0, (Sm)3

KIT INCLUDES:

QTY	MODEL	SIZE	Weight	EDGE
4	London BassTraps	24" x 48" x 2" (61 x 122 x 5cm)	5.3 lbs (1.2 kg) per panel	Beveled
16	Control Columns	12" x 48" x 2" (30.5 x 122 x 5cm)	2.7 lbs (1.2 kg) per panel	Beveled
24	Scatter Blocks	12" x 12" x 1" (30.5 x 30.5 x 2.5cm)	.75 lbs (.35 kg) per panel	Beveled
56	Surface Impaler	For mounting Control Columns and Scatter Blocks. Drywall anchors and screws included.		
16	Corner Impaler	For mounting Broadway panels in room corners to help trap bass frequencies. Drywall anchors and screws included.		

